

Quick Release Broaching Standoff

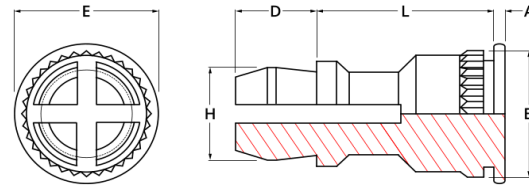

Top panel is snapped into place and can be quickly removed by simply pulling the panel up and away from the standoffs. To reattach simply snap back into place.

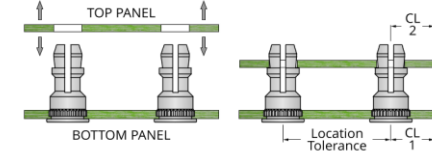

Quick Release Broaching Standoff									
Bottom Panel					Top Panel				
Hole Size	Minimum Panel Thickness	Panel Material	Min. CL 1 To Edge	Location Tolerance	Hole Size	Panel Thk Range	Panel Material	Minimum CL 2 To Edge	Maximum Hardness
+0.08 / -0.00					+0.08/-0.0				
5.41	1.27	PCB	5.59	+ / - 0.13	4.0	1.0 - 1.8	Any	2.54	No Limit

H	D	E	B	Lengths (L) + / - 0.13								
+ / - 0.13	+/- 0.13	+/- 0.13	Max									
4.78	3.58	6.35	5.74	8	10	12	14	16	18	20	22	25

Materials And Finish

Brass Electro Tin Plated

Maximum Recommended Panel Hardness 60HRB

INFORMATION AND DRAWINGS PROVIDED ARE FOR REFERENCE ONLY